

SNCAMA Property Record Card

Parcel ID: 089-097-36-0-40-15-017.00-0

Quick Ref: R14299

Tax Year: 2022

Run Date: 4/5/2026 6:01:23 AM

OWNER NAME AND MAILING ADDRESS

BROXTERMAN REMODELING INC

2207 SW 7TH ST
TOPEKA, KS 66606-1701

PROPERTY SITUS ADDRESS

1111 SW BUCHANAN ST
Topeka, KS 66604

BROXTERMAN REMODELING

LAND BASED CLASSIFICATION SYSTEM

Function: 3610 Warehouse dist **Sfx:** 0
Activity: 3100 Plant, factory, heavy goods st
Ownership: 1100 Private-fee simple
Site: 6000 Developed site - with building

GENERAL PROPERTY INFORMATION

Prop Class: C Commercial & Industrial - C
Living Units:
Zoning: R2
Neighborhood: 310.0 310.0 - WEST CENTER AI
Economic Adj. Factor:
Map / Routing: S08 / CE-D
Tax Unit Group: 001-001

TRACT DESCRIPTION

LAFAYETTE PLACE ADDN , Lot 369 + ,
BUCHANAN ST LOTS 369 THRU 377 (ODDS)
LAFAYETTE PLACE ADD SECTION 36
TOWNSHIP 11 RANGE 15



Image Date: 12/21/2017

PROPERTY FACTORS

Topography: Level - 1
Utilities: All Public - 1
Access: Paved Road - 1, Sidewalk - 6
Fronting: Residential Street - 4
Location: Neighborhood or Spot - 6
Parking Type: On and Off Street - 3
Parking Quantity: Adequate - 2
Parking Proximity: On Site - 3
Parking Covered:
Parking Uncovered: 10

INSPECTION HISTORY

Date	Time	Code	Reason	Appraiser	Contact	Code
12/18/2017	2:15 PM	5	VI	TMB		
06/14/2017	1:00 PM	VI	R	TMB	NOH	
06/25/2009	10:30 AM	0	R	TMB		

BUILDING PERMITS

Number	Amount	Type	Issue Date	Status	% Comp
--------	--------	------	------------	--------	--------

2022 APPRAISED VALUE

Cls	Land	Building	Total
C	22,500	44,600	67,100
Total	22,500	44,600	67,100

2021 APPRAISED VALUE

Cls	Land	Building	Total
C	22,500	43,800	66,300
Total	22,500	43,800	66,300

MISCELLANEOUS IMPROVEMENT VALUES

Class	Value	Reason Code
-------	-------	-------------

NEW CONSTRUCTION

Class	Value	Reason Code
-------	-------	-------------

MARKET LAND INFORMATION

Method	Type	Link	AC/SF	Eff FF	Depth	D-Fact	Inf1	Fact1	Inf2	Fact2	OVRD	Rsn	Cls	Model	Base Size	Base Val	Inc Val	Dec Val	Value Est
Soft	1-Primary Site - 1		18,750				7	60	5					5	20,000.00	2.00	2.00	2.00	22,500

Total Market Land Value 22,500

SNCAMA Property Record Card

Parcel ID: 089-097-36-0-40-15-017.00-0

Quick Ref: R14299

Tax Year: 2022

Run Date: 4/5/2026 6:01:23 AM

GENERAL BUILDING INFORMATION

LBCS Structure Code: 2730-Warehouse structure
 Bldg No. & Name: 1 BROXTERMAN REMODELING
 Identical Units: 1 No. of Units:
 Unit Type:
 MS Mult: MS Zip:

APARTMENT DATA

	1	2	3	4	5	6	7	8
Units:								
BR Type:								
Baths:								

IMPROVEMENT COST SUMMARY

Building RCN: 354,240
 Mkt Adj: 100 Eco Adj:
 Building Value: 47,230
 Other Improvement RCN: 5,350
 Other Improvement Value: 1,190

CALCULATED VALUES

Cost Land: 22,500
 Cost Building: 48,420
 Cost Total: 70,920
 Income Value: 67,100
 Market Value:
 MRA Value:

FINAL VALUES

Value Method: INCOME
 Land Value: 22,500
 Building Value: 44,600
 Final Value: 67,100
 Prior Value:

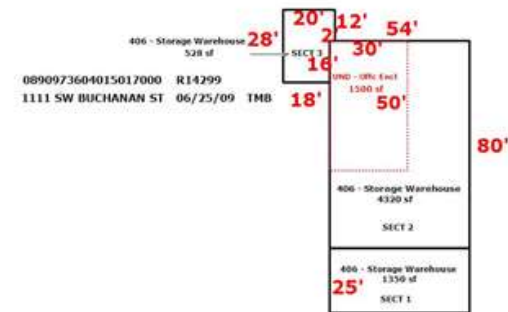

COMMERCIAL BUILDING SECTIONS & BASEMENTS

Sec	Occupancy	MSCIs	Rank	Yr Blt	Eff Yr	Levels	Stories	Area	Perim	Hgt	Phys	Func	Econ	OVR %	Rsn	Inc Use	Net Area	Cls	RCN	% Gd	Value
1	406-Storage Warehouse	C	1.00	1900		01 / 01		1,350	104	16	1	0							59,080	0	0
2	406-Storage Warehouse	C	1.00	1900		01 / 01		4,320	268	30	3	2			045S				267,550	16	42,810
3	406-Storage Warehouse	C	1.00	1900		01 / 01		528	78	13	3	2			045S				27,610	16	4,420

OTHER BUILDING IMPROVEMENTS

No.	Link	Occupancy	MSCIs	Rank	Qty	Yr Blt	Eff Yr	LBCS	Area	Perim	Hgt	Dimensions	Stories	Phys	Func	Econ	OVR%	Rsn	Cls	RCN	%Gd	Value
1		163-Site Improvements	S	2.00	1	1970			10		8				2	2				4,070	26	1,060
2		163-Site Improvements	D	2.00	1	1970			10		8	0032 X 006	1	3	3					1,280	10	130

COMMERCIAL BUILDING SECTION COMPONENTS

Sec	Code	Units	Pct	Size	Other	Rank	Year
1	649-No HVAC		100				
1	807-Brick, Solid		100				
2	612-Warmed and Cooled Air	1,500					
2	807-Brick, Solid		100				
3	649-No HVAC		100				
3	807-Brick, Solid		100				

OTHER BUILDING IMPROVEMENT COMPONENTS

No.	Code	Units	Pct	Size	Other	Rank	Year
1	6604001-Chain Link Fence, Galvanizer	225			6		
2	6602005-Concrete Unreinforced	192			4		