

SNCAMA Property Record Card

Parcel ID: 089-082-04-0-00-01-025.00-0

Quick Ref: R5748

Tax Year: 2025

Run Date: 6/14/2026 8:25:31 PM

OWNER NAME AND MAILING ADDRESS

CAMPBELL, DUSTIN K & JESSIE A

4149 NW HOCH RD
SILVER LAKE, KS 66539

PROPERTY SITUS ADDRESS

4149 NW HOCH RD
Silver Lake, KS 66539

LAND BASED CLASSIFICATION SYSTEM

Function: 1101 Single family re: **Sfx:** 0
Activity: 1100 Household activities
Ownership: 1100 Private-fee simple
Site: 6000 Developed site - with building

GENERAL PROPERTY INFORMATION

Prop Class: R Residential - R
Living Units: 1
Zoning: RA1
Neighborhood: 184.0 184.0 - SILVER LAKE US
Economic Adj. Factor:
Map / Routing: / 020
Tax Unit Group: 204-204

TRACT DESCRIPTION

S04, T11, R14, ACRES 1.44, CAP 600 S & 25 W
NE COR SE 1/4, S 200, W 302(S), N 200, E 302
TO POB



Image Date: 10/02/2023

PROPERTY FACTORS

Topography: Above Street - 2
Utilities: Public Water - 3, Septic - 6, Gas - 7
Access: Paved Road - 1
Fronting: Secondary Street - 3
Location: Neighborhood or Spot - 6
Parking Type: Off Street - 1
Parking Quantity: Adequate - 2
Parking Proximity: On Site - 3
Parking Covered:
Parking Uncovered:

INSPECTION HISTORY

Date	Time	Code	Reason	Appraiser	Contact	Code
10/02/2023	11:33 AM	LG	S	KMM		
06/02/2022	9:25 AM	1	S	KMM	JOSHUA PHELPS	1
07/23/2020	12:00 PM	5	P	KMM		

BUILDING PERMITS

Number	Amount	Type	Issue Date	Status	% Comp
pp20	1	Porch Addition (OFP/SFP/EFP)	04/12/2019	CN	100
C0155	25,000	Dwelling Addition	04/10/2001	C	100
C0184	7,000		05/04/1993	C	100

2025 APPRAISED VALUE

Cls	Land	Building	Total
R	31.100	263.690	294.790
Total	31.100	263.690	294.790

2024 APPRAISED VALUE

Cls	Land	Building	Total
R	30.880	255.320	286.200
Total	30.880	255.320	286.200

MISCELLANEOUS IMPROVEMENT VALUES

Class	Value	Reason Code
-------	-------	-------------

NEW CONSTRUCTION

Class	Value	Reason Code
-------	-------	-------------

MARKET LAND INFORMATION

Method	Type	Link	AC/SF	Eff FF	Depth	D-Fact	Inf1	Fact1	Inf2	Fact2	OVRD	Rsn	Cls	Model	Base Size	Base Val	Inc Val	Dec Val	Value Est
Acre	1-Primary Site - 1		1.44											72	1.00	30,000.00	2,500.00	2,500.00	31,100

Total Market Land Value 31,100

SNCAMA Property Record Card

Parcel ID: 089-082-04-0-00-01-025.00-0

Quick Ref: R5748

Tax Year: 2025

Run Date: 6/14/2026 8:25:31 PM

DWELLING INFORMATION

Res Type: 1-Single-Family Residence
 Quality: 3.00-AV
 Year Blt: 1975 Est:
 Eff Year: Link:
 MS Style: 4-Split Level
 LBCSstruct: 1110-Detached SFR unit
 No. of Units:
 Total Living Area:
 Calculated Area: 1,582
 Main Floor Living Area: 1,582
 Upper Floor Living Area Pct:
 CDU: AV
 CDU Reason:
 Phys/Func/Econ: GD / /
 Ovr Pct Gd/Rsn:
 Remodel:
 Percent Complete:
 Assessment Class:
 MU Cls/Pct:

COMP SALES INFORMATION

Arch Style: 03-Split Level
 Bsmt Type: 4-Full - 4
 Total Rooms: 6 Bedrooms: 3
 Family Rooms: 1
 Full Baths: 2 Half Baths: 1
 Garage Cap: 2
 Foundation: Concrete - 2

IMPROVEMENT COST SUMMARY

Dwelling RCN: 287,700
 Percent Good: 76
 Mkt Adj: 100 Eco Adj: 100
 Building Value: 218,650
 Other Improvement RCN: 27,530
 Other Improvement Value: 12,390

CALCULATED VALUES

Cost Land: 31,100
 Cost Building: 231,040
 Cost Total: 262,140
 Income Value: 0
 Market Value: 311,500
 MRA Value: 294,700
 Weighted Estimate: 320,800

FINAL VALUES

Value Method: IDXVAL
 Land Value: 31,100
 Building Value: 263,690
 Final Value: 294,790
 Prior Value: 286,200

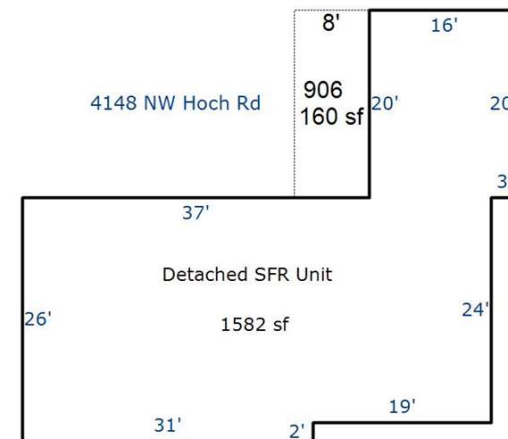

OTHER BUILDING IMPROVEMENTS

No.	Link	Occupancy	MSCIs	Rank	Qty	Yr Blt	Eff Yr	LBCS	Area	Perim	Hgt	Dimensions	Stories	Phys	Func	Econ	OVR%	Rsn	Clis	RCN	%Gd	Value
1		152-Residential Garage - Detach	D	2.00	1	1993			720	108	8	030 X 24	1	3	3					27,530	45	12,390

DWELLING COMPONENTS

Code	Units	Pct	Quality	Year
108-Frame, Siding, Wood		100		
208-Composition Shingle		100		
351-Warmed & Cooled Air		100		
402-Automatic Floor Cover Allowance				
601-Plumbing Fixtures	11			
602-Plumbing Rough-ins	1			
622-Raised Subfloor	1,582			
645-Double 2-Story Fireplace	1			
801-Total Basement Area	1,200			
803-Partition Finish Area	475			
806-Basement Garage, Double	1			

DWELLING COMPONENTS

Code	Units	Pct	Quality	Year
901-Open Slab Porch	285		3.00	1999
903-Wood Deck	160		3.00	1990
903-Wood Deck	288		3.00	2001
906-Wood Deck with Roof	160			