

SNCAMA Property Record Card

Parcel ID: 089-097-36-0-30-07-021.00-0

Quick Ref: R13535

Tax Year: 2026

Run Date: 5/26/2026 12:21:58 PM

OWNER NAME AND MAILING ADDRESS

DESERT ROCK REALTY LLC

917 SW TOPEKA BLVD STE 204
TOPEKA, KS 66612-1609

PROPERTY SITUS ADDRESS

1027 SW WOODWARD AVE
Topeka, KS 66604

LAND BASED CLASSIFICATION SYSTEM

Function: 1101 Single family re: Sfx: 0
Activity: 1100 Household activities
Ownership: 1100 Private-fee simple
Site: 6000 Developed site - with building

GENERAL PROPERTY INFORMATION

Prop Class: R Residential - R
Living Units: 1
Zoning: R2
Neighborhood: 170.4 170.4 - SW 6TH-12TH, W/
Economic Adj. Factor:
Map / Routing: / 000RM
Tax Unit Group: 001-001

TRACT DESCRIPTION

PLEASANT VIEW, S36, T11, R15, Lot 25 +,
WOODWARD AVE LOTS 25-27 PLEASANT VIEW
SUB SECTION 36 TOWNSHIP 11 RANGE 15



Image Date: 09/03/2025

PROPERTY FACTORS

Topography: Level - 1
Utilities: All Public - 1
Access: Paved Road - 1, Alley - 7
Fronting: Residential Street - 4
Location: Neighborhood or Spot - 6
Parking Type: On and Off Street - 3
Parking Quantity: Adequate - 2
Parking Proximity: On Site - 3
Parking Covered:
Parking Uncovered:

INSPECTION HISTORY

Date	Time	Code	Reason	Appraiser	Contact	Code
09/03/2025	12:13 PM	VI	VI	MAM		
12/03/2021	10:15 AM	6	S	MAM		
06/22/2021	3:40 PM	11	P	MAM		

BUILDING PERMITS

Number	Amount	Type	Issue Date	Status	% Comp
MAM22		Interior Remodel	03/19/2021	C	100
MJV08	1	Interior Remodel	09/11/2007	C	100

2026 APPRAISED VALUE

Cls	Land	Building	Total
R	2.060	93.850	95.910
Total	2.060	93.850	95.910

2025 APPRAISED VALUE

Cls	Land	Building	Total
R	2.060	89.280	91.340
Total	2.060	89.280	91.340

MISCELLANEOUS IMPROVEMENT VALUES

Class	Value	Reason Code
-------	-------	-------------

NEW CONSTRUCTION

Class	Value	Reason Code
-------	-------	-------------

MARKET LAND INFORMATION

Method	Type	Link	AC/SF	Eff FF	Depth	D-Fact	Inf1	Fact1	Inf2	Fact2	OVRD	Rsn	Cls	Model	Base Size	Base Val	Inc Val	Dec Val	Value Est
Fron	1-Regular Lot - 1			50	125	0.98								8	50.00	42.00	10.00	10.00	2.060

Total Market Land Value 2,060

SNCAMA Property Record Card

Parcel ID: 089-097-36-0-30-07-021.00-0

Quick Ref: R13535

Tax Year: 2026

Run Date: 5/26/2026 12:21:58 PM

DWELLING INFORMATION

Res Type: 1-Single-Family Residence
 Quality: 2.67-AV-
 Year Blt: 1900 Est: Yes
 Eff Year: Link:
 MS Style: 2-Two Story
 LBCSstruct: 1110-Detached SFR unit
 No. of Units:
 Total Living Area:
 Calculated Area: 864
 Main Floor Living Area: 528
 Upper Floor Living Area Pct: 63.63
 CDU: GD
 CDU Reason: ER
 Phys/Func/Econ: EX / /
 Ovr Pct Gd/Rsn:
 Remodel: 2021 /
 Percent Complete:
 Assessment Class:
 MU Cls/Pct:

COMP SALES INFORMATION

Arch Style: 09-Old Style
 Bsmt Type: 3-Partial - 3
 Total Rooms: 5 Bedrooms: 3
 Family Rooms:
 Full Baths: 1 Half Baths:
 Garage Cap:
 Foundation: Block - 3

IMPROVEMENT COST SUMMARY

Dwelling RCN: 123,210
 Percent Good: 70
 Mkt Adj: 100 Eco Adj: 100
 Building Value: 86,250
 Other Improvement RCN: 0
 Other Improvement Value: 0

CALCULATED VALUES

Cost Land: 2,060
 Cost Building: 86,250
 Cost Total: 88,310
 Income Value: 0
 Market Value: 118,800
 MRA Value: 116,400
 Weighted Estimate: 118,700

FINAL VALUES

Value Method: IDXVAL
 Land Value: 2,060
 Building Value: 93,850
 Final Value: 95,910
 Prior Value: 91,340

1027 SW WOODWARD AVE

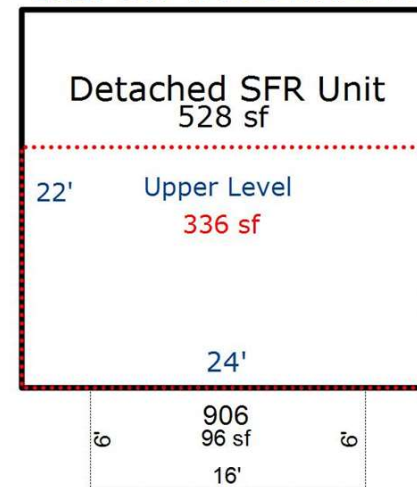

DWELLING COMPONENTS

Code	Units	Pct	Quality	Year
101-Frame, Hardboard Sheets		100		
208-Composition Shingle		100		
351-Warmed & Cooled Air		100		
402-Automatic Floor Cover Allowance				
601-Plumbing Fixtures	5			
602-Plumbing Rough-ins	1			
622-Raised Subfloor	864			
801-Total Basement Area	162			
906-Wood Deck with Roof	96		3.00	2010